

SW-51

960950
26125N

CONGLOMERATE ON N END OF

MULCAHY BAY

S₀: 311/73E S_m 345/86N

A₁ 210/56NW A₁ S₀ → 337

2nd

CLUSTER

LONGITUDE
SW-55

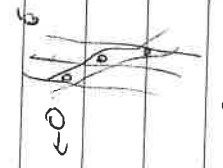
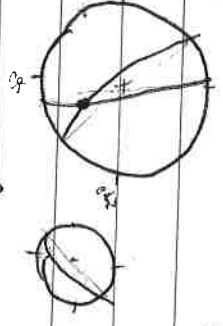

SW-54 SW-53

SW-52

SW-51

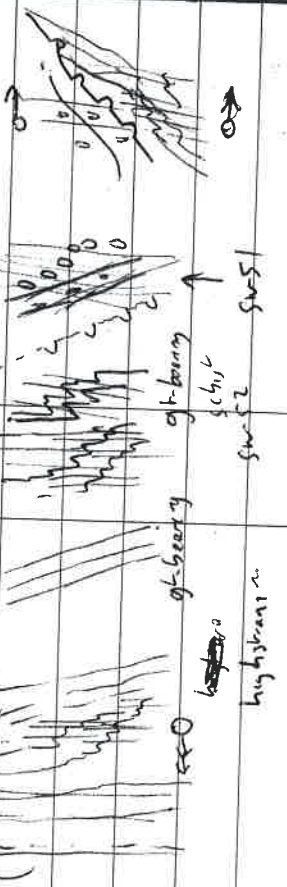

SW-52

MAO

SE

959170
26163N



A₁ 028/76W
A₁ 18/220

S_m 218/86N

SE

NW

S_m 230/52SE

026/74E: S₀

21/207: A

STONG S₀

DUTCHMAN HAS ST

FACE ONLY

200/82E

SW-52 GT-BEARING SCHIST

SW-53 GT-BEARING SCHIST

95906E
26165N

S_m 176/74E

S₀ 352/50E

NOTE: COULD BE INT.

AS C' SURFACE BENT

WITH SIMILAR NOVENARY

MAP VIEW (SW-45)
S: 340/90 N 70

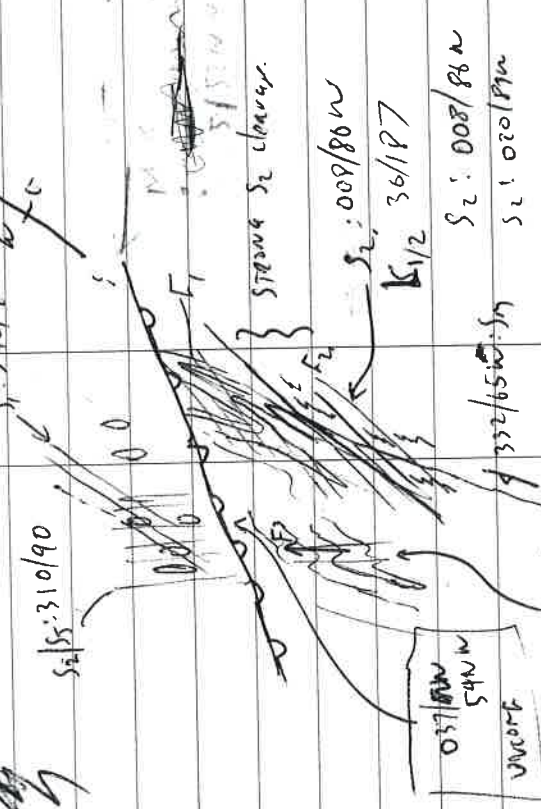

F2: 313/86W: 8, 34/309: A
F1: 335/64W: 8: 40/307 A;
F1: 342/56W: 8: 30/313 A
F2: 347/44W A: 36/308

22/2/04 WALK OUT OF MULLAGH BAY

SW-54 2nd River (drying)

MYCONIE NEXT TO LOW QUARTZITE

S: 009/68E L: 5°S
9540E 26204N
164/74W 164/74W
FACE ONLY

W
S: 348/80W
A: 30/180

Low Sec

Most Western Sm is Vertical

192/90

SW-55 S: 180/78W → 180/78W
9540E 26339N



SW-56
HILLTOP? ANTI-HIDIOGENE
95455E 26409N
182/78E
SW-56

LOW-55
HILLTOP?
182/80W
A: 50/170
S: 182/78E

SW-64	Dagobis, MN	DUT CAR
So: 180/35W		99775E 92277N

EAST	SIDE OF	SYNCHRON
------	---------	----------

gw-65	<u>SUMMIT POINT</u>
25/2/04	Burns Formation W

OC	POURQUEN	50,338/220	50,048W	C
----	----------	------------	---------	---

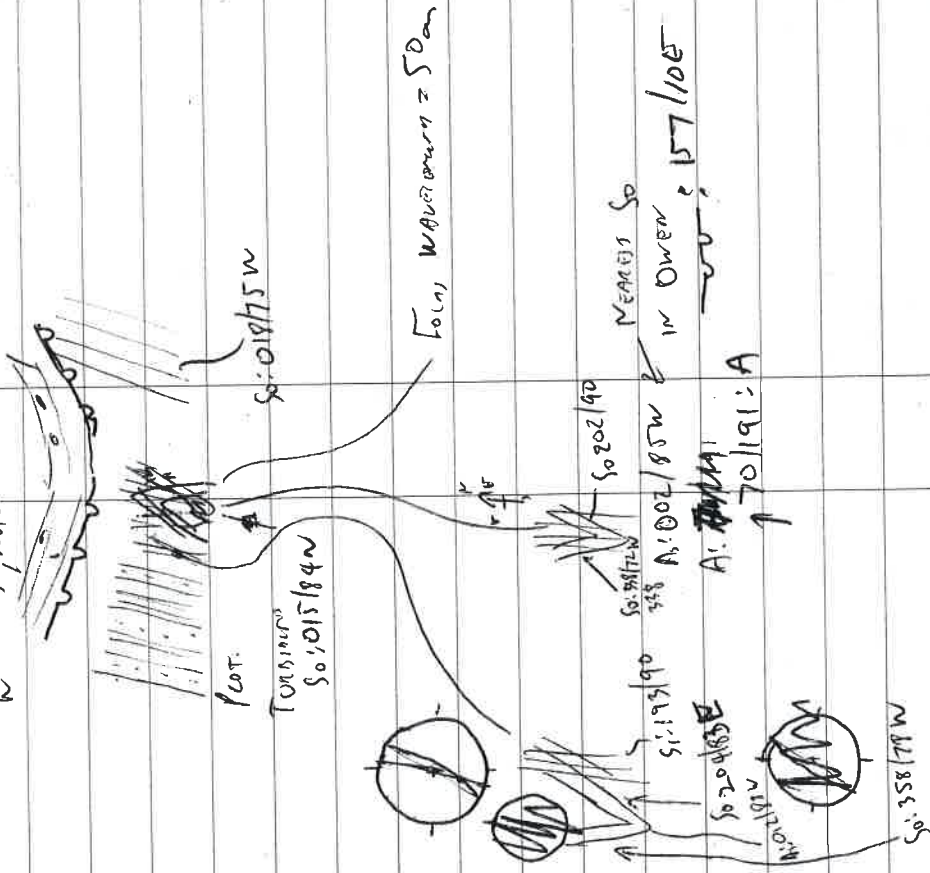

NE TIP OF SUTHERLAND POINT

— 50-342/11W

3

252/13w

$S_{in} = 0.07/54W$

BUREAU OF

$$S_n: 35154w$$

As: 016/58w

LOW GRADE

SLATY/SCLAY CLEARANCE AXIAL PLANE
TO FOLIOS.

2.002/82w

A₃: 354/80w

A: 66/200 (900D 25A01, 22)

8279W

SW-66 Mouth of Bay Tr River.

Buamif
Go
T. ABITES WITH
STONG

MEASURE SOLUTION CLEARANCE

9/16/55

17

5v-67 Boat Lane Sisters Beach
W OF ARTHUR LINDSEY
Rocky Cans Crow SSW-67 01/17/67

TRAIL - QUITE 1100

WELL

QUITE

TABO ORTYEUM?

S: 079750

S:

S: 1564128

NW

1/2

W
S
N

SW-67 Boat Hanson

QUITE / QUANT ARTHUR

S: 102138N

X- Boring

Phonograph

↓ 500
↓ 350

AMP-
MUSC-
X

SO L. GRASS
X

W/G
MUSC

MT
R. GRASS